

ELBPHILHARMONIE

H A M B U R G





MORE THAN JUST A CONCERT HALL

THE ELBPHILHARMONIE HAMBURG

On **11 and 12 January 2017**, Hamburg is celebrating the opening of one of the world's most impressive concert halls. Located on the tip of the Hafencity peninsula, opposite the piers and in close proximity to the Speicherstadt UNESCO World Heritage Site, the Elbphilharmonie's spectacular architecture is an unmissable, eye-catching landmark. Soaring like a wave at 110 metres above the water, the glass facade appears to be hovering above the brick base of the historic quayside warehouse. A unique building that now moulds the Hamburg skyline, reshaping the city and lifting its musical life to new heights.

Locals and tourists, music lovers and architecture aficionados – everyone is invited to get to know the Elbphilharmonie, which was designed by architecture firm **Herzog & de Meuron**: up close by attending concerts in the Grand Hall and Recital Hall, by exploring the Kaistudios, or by staying at the hotel that is housed in the same building. And, of course, the publicly accessible Plaza, Hamburg's new rendezvous, with its unbeatable view over the port and the city. The Elbphilharmonie is symbolic of the maritime, kaleidoscopic flair of the Hanseatic city, which continually reshapes its future by combining tradition and modernity, and expressing courage, creativity and a cosmopolitan openness.



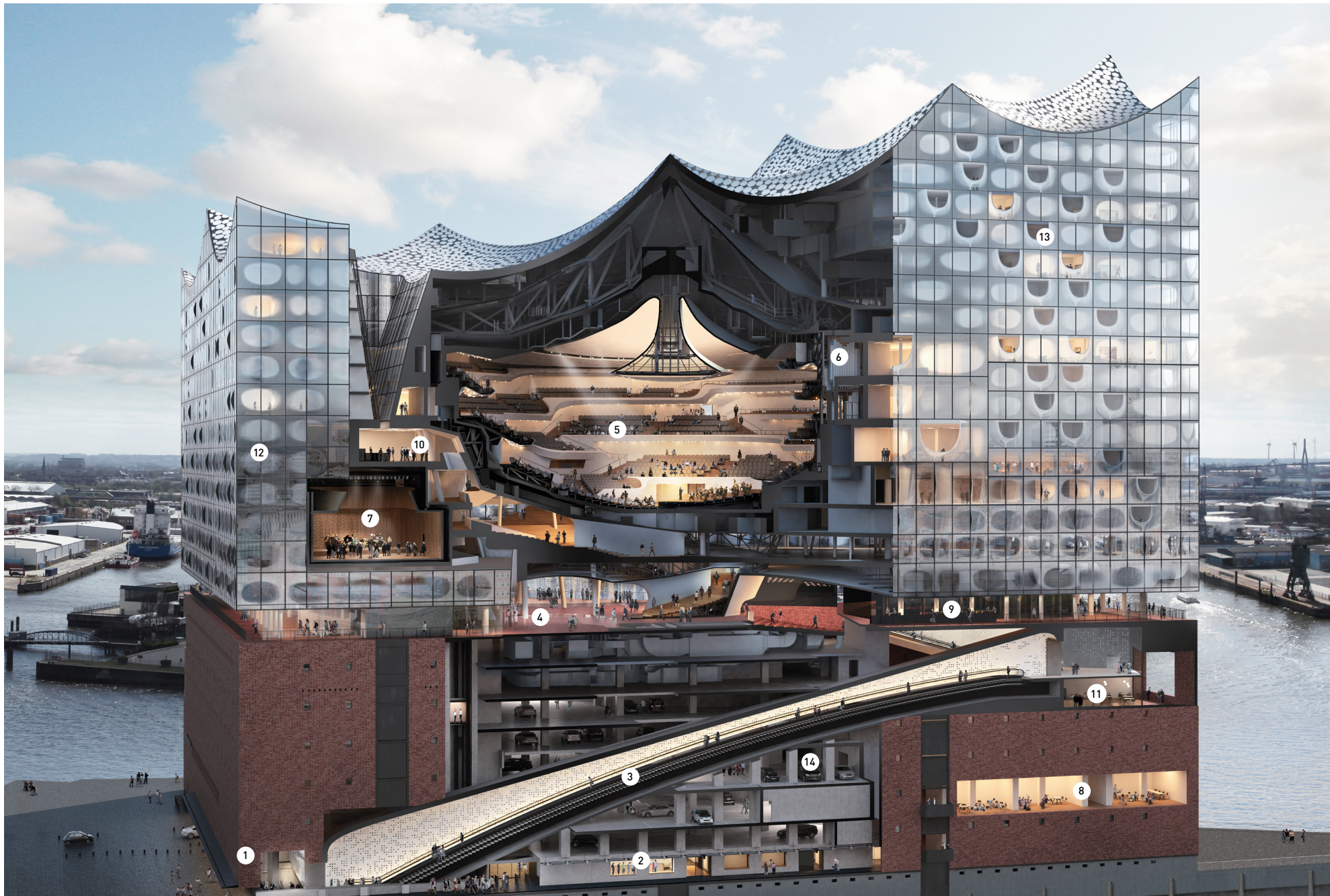

1 Main entrance 2 Elbphilharmonie ticket office 3 Tube 4 Plaza 5 Grand Hall 6 Organ 7 Recital Hall

8 Kaistudios 9 Shop 10 Foyer bar 11 Restaurants/café 12 Hotel 13 Apartments 14 Car park

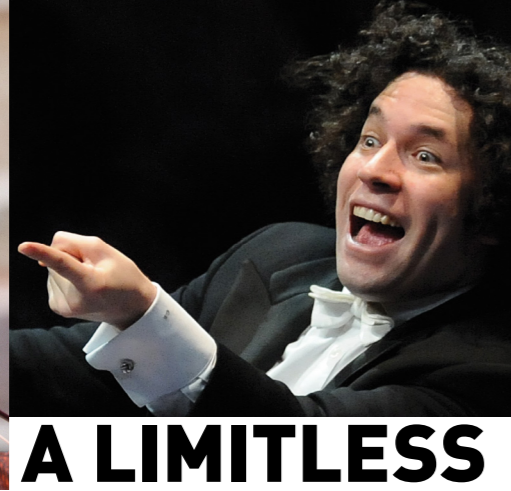

ELBPHILHARMONIE
HAMBURG PRESENTS

A LIMITLESS

MUSICAL EXPERIENCE

“There is no serious music or unserious music, just good music and bad music.” Never before has this legendary quotation (which is attributed to Leonard Bernstein) been as true as in the case of the Elbphilharmonie. The guiding principle behind Hamburg’s new concert hall can be summarised in just two words: good music. A diverse programme awaits audiences here, covering a range of genres – and always at the very highest level.

The Elbphilharmonie sees itself as a “concert hall for everyone”. The musical programme is therefore designed to be varied and inviting, offering captivating concert experiences to both connoisseurs and newcomers alike. Concerts and concertante opera performances in the Grand Hall featuring the best orchestras from around the world represent the epitome of musical achievement. Piano, string quartet and lieder evenings in the Recital Hall offer

a more intimate emotional and acoustic experience. The very best musicians, the most charismatic conductors and the greatest soloists from every corner of the globe visit the Elbphilharmonie as guest performers. And the Hamburg ensembles – most notably the resident orchestra, the NDR Elbphilharmonie Orchestra – also feature in the programme.

However, the Elbphilharmonie offers far more than just classical music. After all, modern concert halls cannot be artistically single-minded. Key focus areas and themed festivals ensure that there is a structure to the programme. Audiences are treated to jazz and world music by the biggest names on the scene, as well as cutting-edge, intelligent pop, folk and cross-over music. Even the legendary German industrial band “Einstürzende Neubauten” are performing at the opening festival. There are also several projects that cannot

be pigeonholed in terms of genre. The pioneer Brian Eno is designing a sound installation exclusively for the Elbphilharmonie, and choreographer Sasha Waltz is presenting a dance performance. Hollywood star John Malkovich celebrates the world premiere of his latest musical theatre piece in Hamburg.

The Elbphilharmonie wants to make the wonderful world of music accessible to as many people as possible. The challenge in this regard is to eliminate barriers and to make people for who attending a concert is not (yet) a natural impulse feel welcome. Great importance is therefore attached to concerts for young children, school pupils and families. The new “World of Instruments”, with its wide and diverse range of creative workshops, offers people of all ages the chance to get to know and play musical instruments of all kinds. The Elbphilharmonie has even brought together and established

ensembles of its own. The programme also includes artists in conversation, pre-concert talks and special events – ensuring an unforgettable concert experience for all.

**BE IT A MAJOR SYMPHONY CONCERT,
PIANO OR CHAMBER MUSIC,
JAZZ, POP, ROCK OR WORLD MUSIC:
AT THE ELBPHILHARMONIE THERE
IS SOMETHING FOR EVERYONE,
FROM BABIES TO PENSIONERS .**

Concert selection: Brian Eno 05/11/2016–04/12/2016 Sasha Waltz 01/01/2017–04/01/2017 Brad Mehldau solo 16/01/2017 Mitsuko Uchida 18/01/2017 + 23/02/2017 Einstürzende Neubauten 21/01/2017 Wiener Philharmoniker / Bychkov 22/01/2017 Yo-Yo Ma 24/01/2017 + 26/01/2017 Thomas Hampson 25/01/2017 Quatuor Ebène 26/01/2017 Cecilia Bartoli 13/02/2017 Paolo Conte 25/02/2017 Belcea Quartet 26/02/2017 Ian Bostridge 28/02/2017 Alice Sara Ott 01/03/2017 Pierre-Laurent Aimard 03/03/2017 Wolfgang Muthspiel Quintet 07/03/2017 John Malkovich 08/03/2017 – 10/03/2017 Richard Galliano & Ron Carter 14/03/2017 The Voice of Ancient Syria: Ibrahim Keivo 18/03/2017 Orquesta Sinfónica Simón

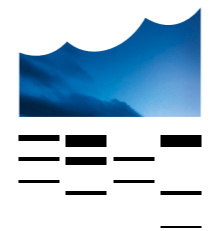

Bolívar / Dudamel 19/03/2017–23/03/2017 Lang Lang 25/03/2017 Branford Marsalis Quartet 28/03/2017 Hagen Quartett 29/03/2017 John Zorn Marathon 30/03/2017 JACK Quartet 31/03/2017 New York Philharmonic / Gilbert 03/04/2017 + 04/04/2017 Hélène Grimaud 08/04/2017 Mariza 15/04/2017 Somi 21/04/2017 Chick Corea 25/04/2017 Anoushka Shankar 10/05/2017 Joyce DiDonato 14/05/2017 Symphonieorchester des Bayerischen Rundfunks / Jansons 20/05/2017 Tomatito 28/05/2017 Mahler Chamber Orchestra / Currentzis 29/05/2017 La Fura dels Baus 05/06/2017 + 06/06/2017 Martin Grubinger 10/06/2017 + 11/06/2017 Long Night of Organ 17/06/2017 // NDR Elbphilharmonie Orchestra / Hamburg Philharmonic State Orchestra / Ensemble Resonanz

A TOTAL WORK OF ART

THE ELBPHILHARMONIE IS FAR MORE THAN JUST A CONCERT HALL

The interior of the Elbphilharmonie building is designed to be just as captivating as the contoured, reflective glass facade on the outside. The core is the **Grand Hall** with 2,100 seats. It opens up a completely new musical experience based on the synergy of sound and space, acoustic perfection and the proximity between artists and audience. It is designed in the “vineyard” style, with the stage situated at the centre, surrounded by terraced seating. The **white skin** – a wall cladding with a customised surface that reflects sounds in all directions – guarantees perfect acoustics. It was developed by architecture firm Herzog & de Meuron and the Japanese star acoustician Yasuhisa Toyota. An **organ** with 4,765 pipes has also been installed.



There is also a multifunctional **Recital Hall** with a capacity of 550 people, as well as several **Kaistudios** for smaller concert formats, rehearsals and workshops. This is also where the interactive “World of Instruments” is located. The Elbphilharmonie also houses a **hotel** with 250 rooms, apartments, a car park and as a number of **restaurants and cafés**.

At a height of 37 metres above ground level, the **Plaza** is found at the junction between the brick base and the new glass structure above it. It is an open platform that can be accessed by visitors from Hamburg and around the world at any time of day, and offers a spectacular panoramic view over the diverse cityscape: the piers, the Elbe river, the busy port, the elegant city centre, the lively district of St. Pauli and green parks. Just as impressive as the view over the “metropolis by the water” is the route into the Elbphilharmonie through the **Tube** – an 82-metre-long, curved escalator.



Despite its futuristic architecture the Elbphilharmonie is standing, quite literally, on **historic ground**. A warehouse for cocoa, coffee and other goods was built on the site in 1875. This original “Kaispeicher” was badly damaged during the Second World War. In 1963 the “Kaispeicher A” was built, but that became obsolete with the growth of container trade; today, it forms the base for the Elbphilharmonie.

The Elbphilharmonie is firmly anchored in the **city’s musical life**, which has always been characterised by a contrast between the raw and the refined: from classical composers such as Brahms and Telemann to the Beatles and Udo Lindenberg, from countless trendy clubs to major festivals and musicals, from electro and rap to the Laeiszhalle and the State Opera House. The Elbphilharmonie is fitting in and finding its place in this lively cultural environment – while at the same time elevating it to new international heights.



CONCERT TICKETS

www.elbphilharmonie.com

phone: +49 40 357 666 66

PLAZA TICKETS

Plaza opening times: from 5 November 2016, 09:00 – 00:00.

Tickets for visits on the same day can be obtained for free at the Elbphilharmonie

There is a charge of € 2.00 per ticket when booking in advance.

Available from 17 October 2016:

At the Elbphilharmonie Visitor Centre, Am Kaiserkai 60–62

At the ticket machines in the Plaza foyer

Online at www.elbphilharmonie.com

A concert ticket allows access to the Plaza up to two hours before the start of the event.

ELBPILHARMONIE GUIDED TOURS

Daily from February 2017. Dates, information and tickets from 4 November 2016

at www.elbphilharmonie.com

www.elbphilharmonie.com

www.elbphilharmonie.de/en/newsletter

[Facebook.com/elbphilharmonie.hamburg](https://www.facebook.com/elbphilharmonie.hamburg)

[Twitter.com/elbphilharmonie](https://twitter.com/elbphilharmonie)

App: Elbphilharmonie Hamburg 3D – available for iOS and Android

COUNTDOWN.ELBPILHARMONIE.DE/EN



**MONT
BLANC**

 Hamburg